

**C FLANGE ADDITION DIMENSIONS**

| NEMA C-Face | BA Dimensions |
|-------------|---------------|
| 143-5TC     | 2-3/4         |
| 182-4TC     | 3-1/2         |
| 213-5TC     | 4-1/4         |
| 254-6TC     | 4-3/4         |

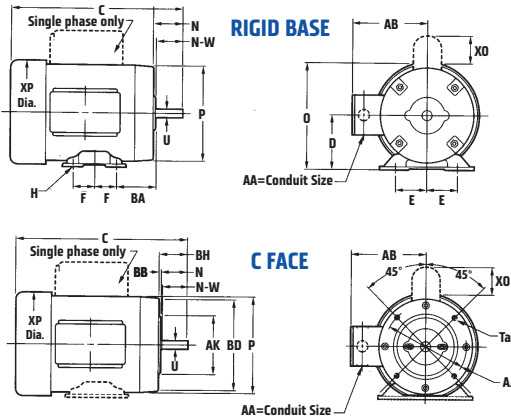

**KEYSEAT DIMENSIONS**

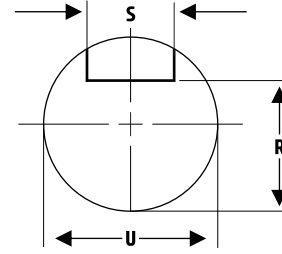

| NEMA SHAFT (U) | KEY (R) | DIMEN (S) |
|----------------|---------|-----------|
| 3/8            | 21/64   | Flat      |
| 1/2            | 29/64   | Flat      |
| 5/8            | 33/64   | 3/16      |
| 7/8            | 49/64   | 3/16      |
| 1-1/8          | 63/64   | 1/4       |
| 1-3/8          | 1-13/64 | 5/16      |
| 1-5/8          | 1-13/32 | 3/8       |
| 1-7/8          | 1-19/32 | 1/2       |
| 2-1/8          | 1-27/32 | 1/2       |
| 2-3/8          | 2-1/64  | 5/8       |
| 2-1/2          | 2-3/16  | 5/8       |
| 2-7/8          | 2-29/64 | 3/4       |
| 3-3/8          | 2-7/8   | 7/8       |
| 3-7/8          | 3-5/16  | 1         |

| FRAME  | D     | E      | 2F   | H             | N*   | O*   | P*   | U  | V  | AA    | AB*  | AH   | AJ                               | AK                               | BA     | BB                           | BD*                      | TAP                                  |
|--|-------|--------|--|---------------|--|--|--|--|--|-------|--|--|----------------------------------|----------------------------------|--------|------------------------------|--------------------------|--------------------------------------|
| 42   | 2-5/8 | 1-3/4  | 1-11/16  | 9/32<br>SLOT  | 1-1/2  | 5  | 4-11/16  | 3/8  | 1-1/8  | 3/8   | 4-1/32   | 1-5/16   | 3-3/4                            | 3                                | 2-1/16 | 1/8                          | 4-5/8                    | 1/4-20                               |
| 48   | 3     | 2-1/8  | 2-3/4  | 11/32<br>SLOT | 1-7/8  | 5-7/8  | 5-11/16  | 1/2  | 1-1/2  | 1/2   | 4-3/8  | 1-11/16  | 3-3/4                            | 3                                | 2-1/2  | 1/8                          | 5-5/8                    | 1/4-20                               |
| 56<br>56H  | 3-1/2 | 2-7/16 | 3<br>5   | 11/32<br>SLOT | 2-7/16<br>2-1/8  | 6-7/8  | 6-5/8  | 5/8  | 1-7/8  | 1/2   | 5  | 2-1/16   | 5-7/8                            | 4-1/2                            | 2-3/4  | 1/8                          | 6-1/2                    | 3/8-16                               |
| 143T<br>145T   | 3-1/2 | 2-3/4  | 4<br>5   | 11/32         | 2-1/2  | 6-7/8  | 6-5/8  | 7/8  | 2-1/4  | 3/4   | 5-1/4  | 2-1/8  | 5-7/8                            | 4-1/2                            | 2-1/4  | 1/8                          | 6-1/2                    | 3/8-16                               |
| 182<br>184<br>182T<br>184T   | 4-1/2 | 3-3/4  | 4-1/2<br>5-1/2<br>4-1/2<br>5-1/2   | 13/32         | 2-11/16<br>2-11/16<br>3-9/16<br>3-9/16   | 8-11/16  | 7-7/8  | 7/8<br>7/8<br>1-1/8<br>1-1/8                       | 2-1/4<br>2-1/4<br>2-3/4<br>2-3/4   | 3-1/4 | 5-7/8  | 2-1/8<br>2-1/8<br>2-5/8<br>2-5/8   | 5-7/8<br>5-7/8<br>7-1/4<br>7-1/4 | 4-1/2<br>4-1/4<br>8-1/2<br>8-1/2 | 2-3/4  | 1/8<br>1/8<br>1-1/4<br>1-1/4 | 6-1/2<br>6-1/2<br>9<br>9 | 3/8-16<br>3/8-16<br>1/2-13<br>1/2-13 |
| 213<br>215<br>213T<br>215T   | 5-1/4 | 4-1/4  | 5-1/2<br>7<br>5-1/2<br>7   | 13/32         | 3-1/2<br>3-1/2<br>3-7/8<br>3-7/8   | 10-1/4   | 9-9/16   | 1-1/8<br>1-1/8<br>1-3/8<br>1-3/8                   | 3<br>3<br>3-3/8<br>3-3/8   | 3/4   | 7-3/8  | 2-3/4<br>2-3/4<br>3-1/8<br>3-1/8   | 7-1/4                            | 8-1/2                            | 3-1/2  | 1/4                          | 9                        | 1/2-13                               |
| 254U<br>256U<br>254T<br>256T   | 6-1/4 | 5      | 8-1/4<br>10<br>8-1/4<br>10   | 17/32         | 4-1/16<br>4-1/16<br>4-5/16<br>4-5/16   | 12-7/8   | 12-15/16   | 1-3/8<br>1-3/8<br>1-5/8<br>1-5/8                   | 3-3/4<br>3-3/4<br>4<br>4   | 1     | 9-5/8  | 3-1/2<br>3-1/2<br>3-1/4<br>3-1/4   | 7-1/4                            | 8-1/2                            | 4-1/4  | 1/4                          | 10                       | 1/2-13                               |
| 284U<br>286U<br>284T<br>286T<br>284TS<br>286TS                                   | 7     | 5-1/2  | 9-1/2<br>11<br>9-1/2<br>11<br>9-1/2<br>11  | 17/32         | 5-1/8<br>5-1/8<br>4-7/8<br>4-7/8<br>3-3/8<br>3-3/8   | 14-5/8   | 14-5/8   | 1-5/8<br>1-5/8<br>1-7/8<br>1-7/8<br>1-5/8<br>1-5/8 | 4-7/8<br>4-7/8<br>4-5/8<br>4-5/8<br>3-1/4<br>3-1/4                                     | 1-1/2 | 13-1/8   | 4-5/8<br>4-5/8<br>4-3/8<br>4-3/8<br>3<br>3   | 9                                | 10-1/2                           | 4-3/4  | 1/4                          | 11-1/4                   | 1/2-13                               |
| 324U<br>326U<br>324T<br>326T<br>324TS<br>326TS                                   | 8     | 6-1/4  | 10-1/2<br>12<br>10-1/2<br>12<br>10-1/2<br>12                                     | 21/32         | 5-7/8<br>5-7/8<br>5-1/2<br>5-1/2<br>3-15/16<br>3-15/16   | 16-1/2   | 16-1/2   | 1-7/8<br>1-7/8<br>2-1/8<br>2-1/8<br>2-1/8<br>2-1/8 | 5-5/8<br>5-5/8<br>5-1/4<br>5-1/4<br>5-1/4<br>5-1/4                                     | 2     | 14-1/8   | 5-3/8<br>5-3/8<br>5<br>5<br>5<br>5   | 11                               | 12-1/2                           | 5-1/4  | 1/4                          | 13-3/8                   | 5/8-11                               |
| 364U<br>365U<br>364T<br>365T<br>364TS<br>365TS                                   | 9     | 7      | 11-1/4<br>12-1/4<br>11-1/4<br>12-1/4<br>11-1/4<br>12-1/4                         | 21/32         | 6-3/4<br>6-3/4<br>6-1/4<br>6-1/4<br>4<br>4   | 18-1/2   | 18-1/4   | 2-1/8<br>2-1/8<br>2-3/8<br>2-3/8<br>1-7/8<br>1-7/8 | 6-3/8<br>6-3/8<br>5-7/8<br>5-7/8<br>3-3/4<br>3-3/4                                     | 2-1/2 | 15-1/16  | 6-1/6<br>6-1/6<br>5-5/8<br>5-5/8<br>3-1/2<br>3-1/2                                     | 11                               | 12-1/2                           | 5-7/8  | 1/4                          | 13-3/8                   | 5/8-11                               |
| 404U<br>405U<br>404T<br>405T<br>404TS<br>405TS                                   | 10    | 8      | 12-1/4<br>13-3/4<br>12-1/4<br>13-3/4<br>12-1/4<br>13-3/4                         | 13/16         | 7-3/16<br>7-3/16<br>7-5/16<br>7-5/16<br>4-1/2<br>4-1/2   | 20-5/16  | 20-1/8   | 2-3/8<br>2-3/8<br>2-7/8<br>2-7/8<br>2-1/8<br>2-1/8 | 7-1/8<br>7-1/8<br>7-1/4<br>7-1/4<br>4-1/4<br>4-1/4                                     | 3     | 18   | 6-7/8<br>6-7/8<br>7<br>7<br>4<br>4   | 11                               | 12-1/2                           | 6-5/8  | 1/4                          | 13-7/8                   | 5/8-11                               |
| 444U<br>445U<br>444T<br>445T<br>447T<br>449T<br>444TS<br>445TS<br>447TS<br>449TS | 11    | 9      | 14-1/2<br>16-1/2<br>14-1/2<br>16-1/2<br>20<br>25<br>14-1/2<br>16-1/2<br>20<br>25 | 13/16         | 8-5/8<br>8-5/8<br>8-1/2<br>8-1/2<br>8-15/16<br>8-15/16<br>5-3/16<br>5-3/16<br>4-15/16<br>4-15/16 | 22-7/8<br>22-7/8<br>22-7/8<br>22-7/8<br>22-15/16<br>22-15/16<br>22-7/8<br>22-7/8<br>22-3/4<br>22-3/4 | 22-3/8<br>22-3/8<br>22-3/8<br>22-3/8<br>22-3/4<br>22-3/4 | 2-7/8<br>2-7/8<br>2-7/8<br>2-7/8<br>3-3/8<br>3-3/8 | 8-5/8<br>8-5/8<br>8-1/2<br>8-1/2<br>8-1/2<br>8-1/2<br>4-3/4<br>4-3/4<br>4-3/4<br>4-3/4 | 3     | 19-9/16<br>19-9/16<br>19-9/16<br>19-9/16<br>21-11/16<br>21-11/16 | 8-3/8<br>8-3/8<br>8-1/4<br>8-1/4<br>8-1/4<br>8-1/4<br>4-1/2<br>4-1/2<br>4-1/2<br>4-1/2 | 14                               | 16                               | 7-1/2  | 1/4                          | 16-3/4                   | 5/8-11                               |

\* Approximate value; dimensions are specific to individual manufacturers.